

# NewNight® Pole top luminaire PIN-BOARD 1S

Streets - parking lot - settlement and district lighting

## Information

- Pole top luminaire of the newest generation
- FuturePROOF > all components independently changeable
- Ready for connection and easy to install and maintain
- Easy integration into existing lighting towers
- Low weight and low wind load
- Highest efficiency of all system components - LongLIFE• Different light distributions possible
- Changeable LED-Module with FlexPIN Technology
- High-performance lens system made of PMMA (UV-resistant)
- ThermoProtect System against overtemperature of the LED
- Vibration-resistant



LS12 ME600  
Lighting for one or two-sided  
arrangement of poles, also  
with lower mounting heights  
and larger distances

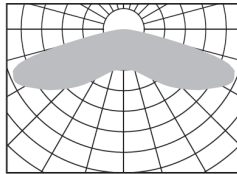

LS12 ME612  
Lighting for pedestrian and  
bicycle paths with one sided  
arrangement of poles, also  
with lower mounting heights  
and larger distances

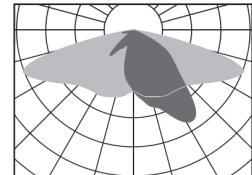

## Technical Informations

Betriebsgeräte:	BRAUN® 3LENS PIN-Modul LS12
Breite:	54 mm
Farbtemperaturen:	3000K, 4000K, 5700K , 2700K, 3500K
Gehäuse:	Aluminum painted to RAL or DB
Gewicht:	1,7 kg
Höhe:	140 mm
Länge:	280 mm
Lebensdauer:	L80 60.000 - 100.000 h
Leistungsaufnahme :	30 Watt
Lichtstrom:	2538lm on 4000K
Optische Abdeckung :	High-performance PMMA lens system (UV-resistant)
Schaltfunktionen:	Eco (on/off)   Basic E1   Light E2   DALI
Schutzklasse :	IP67   SKI (SKII on demand)
Technische Informationen :	

BRAUN Lighting Solutions e. K. is a participant in the export initiative "Energie Effizienz – made in Germany", initiated by the Federal Ministry for the Economy and Technology. Due to the complexity of the many possible combinations of drivers and LED modules, the values shown for technical LED parameters, including performance parameters, are typical. Actual values of specific products in specific configurations may vary from these typical values. The information and diagrams contained in this document do not constitute an offer or contractual obligation. Product parameters may change as a result of technical innovation and will be undertaken without prior notice. Our manufacturing conforms to DIN EN and VDE regulations; the product conforms to European EMC regulations.

BRAUN Lighting Solutions  
Nunsdorfer Ring 2-10  
12277 Berlin  
Germany

www.braun.lighting  
info@braun-lighting.com  
+49 (0)30 7 007 763-100  
+49 (0)30 7 007 763-101



# NewNight® Pole top luminaire PIN-BOARD 1S

Streets - parking lot - settlement and district lighting

Verwendung:	Streets - parking lot - settlement and district lighting
Zubehör:	Basic E1: Power consumption adjustable - manually adjustable of basic brightness Light E2: Power consumption adjustable - manually adjustable of basic brightness and reduced brightness DALI: Interface wire to wire Surge protection 10kA Adapter for spigot Ø60mm Special painting
Zulässige Betriebsspannung:	90-305VAC, 50/60Hz
Zulässige Umgebungstemperatur:	- 40°C up to 50°C

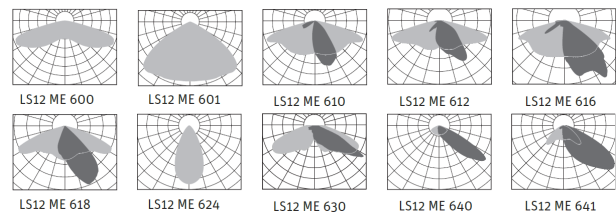
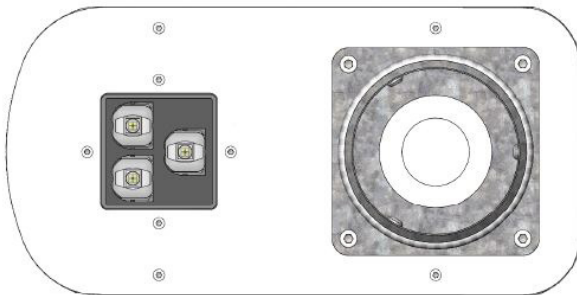
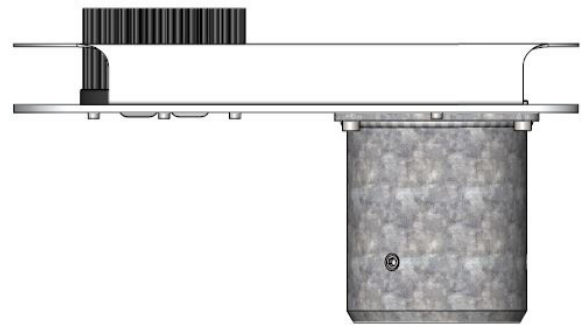

Freely selectable light distributions

BRAUN Lighting Solutions e. K. is a participant in the export initiative "Energie Effizienz – made in Germany", initiated by the Federal Ministry for the Economy and Technology. Due to the complexity of the many possible combinations of drivers and LED modules, the values shown for technical LED parameters, including performance parameters, are typical. Actual values of specific products in specific configurations may vary from these typical values. The information and diagrams contained in this document do not constitute an offer or contractual obligation. Product parameters may change as a result of technical innovation and will be undertaken without prior notice. Our manufacturing conforms to DIN EN and VDE regulations; the product conforms to European EMC regulations.

BRAUN Lighting Solutions  
Nunsdorfer Ring 2-10  
12277 Berlin  
Germany

www.braun.lighting  
info@braun-lighting.com  
+49 (0)30 7 007 763-100  
+49 (0)30 7 007 763-101



# NewNight® Pole top luminaire PIN-BOARD 1S

Streets - parking lot - settlement and district lighting

---

## » Variante Eco:

---

- Luminous flux: 2538lm on 4000K
  - Recommended mounting height: 3 up to 5m
  - power consumption: 30 Watt
  - Manually via 10-stage code switch: No
  - 0-10V | 1-10V Interface| Dim-to-Off: Yes
  - AstroDimm: Yes
  - Dali interface: No
  - Half-night switching via control voltage 230Vac: No
- 

## » Variante Basic E1:

---

- Luminous flux: 2538lm on 4000K
  - Recommended mounting height: 3 up to 5m
  - power consumption: 5 - 30 Watt
  - Manually via 10-stage code switch: Yes
  - 0-10V | 1-10V Interface| Dim-to-Off: No
  - AstroDimm: Yes
  - Dali interface: No
  - Half-night switching via control voltage 230Vac: No
- 

## » Variante Light E2:

---

- Luminous flux: 2538lm on 4000K
  - Recommended mounting height: 3 up to 5m
  - power consumption: 5 - 30 Watt
  - Manually via 10-stage code switch: Yes
  - 0-10V | 1-10V Interface| Dim-to-Off: No
  - AstroDimm: Yes
  - Dali interface: No
  - Half-night switching via control voltage 230Vac: Yes
- 

## » Variante DALI:





---

- Luminous flux: 2538lm on 4000K
  - Recommended mounting height: 3 up to 5m
  - power consumption: 1 - 30 Watt
  - Manually via 10-stage code switch: No
  - 0-10V | 1-10V Interface| Dim-to-Off: No
  - AstroDimm: Yes
  - Dali interface: Yes
  - Half-night switching via control voltage 230Vac: No
- 

BRAUN Lighting Solutions e. K. is a participant in the export initiative "Energie Effizienz – made in Germany", initiated by the Federal Ministry for the Economy and Technology. Due to the complexity of the many possible combinations of drivers and LED modules, the values shown for technical LED parameters, including performance parameters, are typical. Actual values of specific products in specific configurations may vary from these typical values. The information and diagrams contained in this document do not constitute an offer or contractual obligation. Product parameters may change as a result of technical innovation and will be undertaken without prior notice. Our manufacturing conforms to DIN EN and VDE regulations; the product conforms to European EMC regulations.

---

BRAUN Lighting Solutions  
Nunsdorfer Ring 2-10  
12277 Berlin  
Germany

 [www.braun.lighting](http://www.braun.lighting)  
 [info@braun-lighting.com](mailto:info@braun-lighting.com)  
 +49 (0)30 7 007 763-100  
 +49 (0)30 7 007 763-101

